

# HabasitLINK<sup>®</sup>

## M3843 Tight Radius GripTop 1.5"



Your Source For Habasit  
Belting And Chain

www.StilesEnterprises.com • 1-800-325-4232

### Description

- For radius and straight conveying, ideal for applications with limited space, with inclines (collapse factor 1.6)
- 31% open area; 50% open contact area; largest opening 7x19 mm (0.27"x0.75")
- Indent 30 mm (1.18")
- Abrasion resistant GripTop, high friction
- Food approved materials available
- Rod diameter 6 mm (0.24")
- Steel rods every 4th row when fully covered with rubber
- "Open window" sprockets

### Accessories

- Flights M3840: minimum indent 105 / 95 mm (4.1" / 3.7")
- Sideguards
- Hold down modules

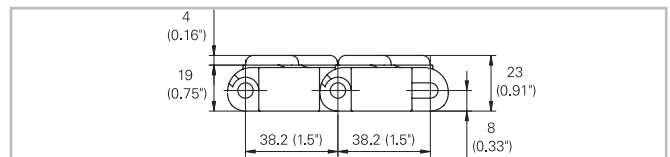

### Belt data

Belt material		PP		POM	
GripTop material		TPE			
Rod material		POM / Steel		PA / Steel	
Nominal tensile strength $F'_N$ straight run	N/m	20000	20000	29000	
	lb/ft	1370	1370	1986	
Nominal tensile strength $F'_N$ in curve <sup>(1)</sup>	N	1800	1800	2250	
	lbf	405	405	506	
Temperature range	°C	5 - 60	5 - 60	-40 - 60	
	°F	40 - 140	40 - 140	-40 - 140	
Belt weight $m_B$	kg/m <sup>2</sup>	8.9	8.9	12.7	
	lb/sqft	1.83	1.83	2.60	

<sup>(1)</sup> For  $b_0 > 600$  mm (23.6") higher admissible values are admissible.

Stainless steel rods are needed in every 4th row if GripTop modules are applied every row (fully covered with rubber).

Use GripTop modules in every second row and M3843 middle modules in the intermediate rows to achieve a sufficient lateral stiffness without using steel rods (in this case the belt weight is around 10% less than the value indicated in the table).

Diameter of idling rollers (minimum)		Diameter of support rollers (minimum)		Diameter for gravity take-up and center drive rollers (minimum)		Backbending radius for elevators without side guards or hold down devices (minimum)		Backbending radius for elevators with sideguards or hold down devices (minimum)	
mm	inch	mm	inch	mm	inch	mm	inch	mm	inch
60	2.4	100	4	150	6	150	6	250	10

Use the largest possible backbending radius for elevators with side guards or hold down devices.